

Electric Characteristics

Type	LDK-220 P-20	LDK-225 P-20	LDK-230 P-20	LDK-235 P-20	LDK-240 P-20	LDK-245 P-20	LDK-250 P-20
Max Power at STC*(Pmax) [W]	220	225	230	235	240	245	250
Max Power Tolerance [%]	±3						
Max Power Voltage (Vmp) [V]	29.8	29.9	29.9	30.0	30.0	30.1	30.2
Max Power Current (Imp) [A]	7.40	7.53	7.68	7.84	7.98	8.14	8.28
Open Circuit Voltage (Voc) [V]	36.5	36.7	36.8	36.8	36.9	37.2	37.5
Short Circuit Current (Isc) [A]	8.14	8.24	8.34	8.35	8.35	8.48	8.59
Maximum System Voltage (VDC) [V]	1000						
Module Efficiency η_m [%]	13.48	13.79	14.09	14.40	14.70	15.01	15.32
Solar Cell Typ	Polycrystalline Silicon Solar Cells 156 x 156 mm						
Number of Cells	60 (6 x 10)						
Temperature Coefficient of Pmax [% / °C]	-0.45						
Temperature Coefficient of Voc [% / °C]	-(0.34 ± 0.01)						
Temperature Coefficient of Isc [% / °C]	0.065						
NOCT (Nominal Operation Cell Temperature) [°C]	45±2						

STC* (Standard Test Condition): Irradiance $1000W / m^2$, Module Temperature $25^{\circ}C$, Air Mass 1.5

Mechanical Characteristics	
Dimensions of Module A*B*C [mm]	1642*994*40
Weight [kg]	20
Connector	MC4

Packing Configuration	
Packing Configuration	24 pcs./box
Quantity / Pallet	48 pcs./pallet
Lording Capacity	624 pcs./40ft(H)

Website: www.ldksolar.com

Ldk Solar reserve the rights to make specifications changes without any prior notice.
All rights reserved.

Absolute Ratings

Maximum System Voltage (VDC) [V]	1000
Operating Temperature [$^{\circ}\text{C}$]	-40~+85
Storage Temperature [$^{\circ}\text{C}$]	-40~+85

Dimensions

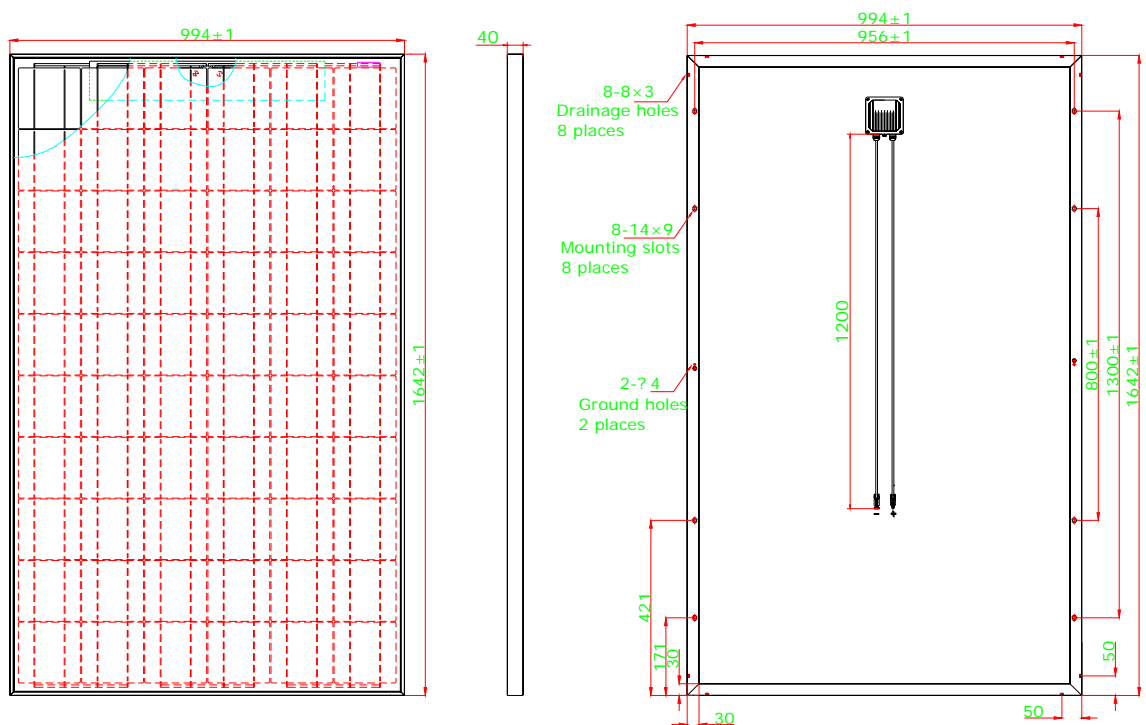

Warranty

Manufacturer	5 years
Power Output	90% for 12 years and 80% for 25 years

Certifications

IEC61215, IEC61730, UL1703, CE

Website: www.ldksolar.com

Ldk Solar reserve the rights to make specifications changes without any prior notice.
All rights reserved.